

SPANNERS

The key to success: perfect work results can only be reached with the perfect spanner. The name GEDORE stands for exact nominal dimensions, long service life, full torque transmission and work safety worldwide.

The GEDORE story began with the spanner in 1919. Since then, the range of open-end, ring, ring ratchet and special spanners has grown steadily. Classics such as the No. 6 and the 7R ratchet spanner continue to set standards in terms of precision and reliability. All GEDORE spanners are manufactured from high-quality steel in a forging

furnace, have precise nominal dimensions and a complex surface finish. Quality made in Germany for optimum working quality and safety.



PRECISION, CORRECT MEASUREMENTS AND PERFECT FIT

- The most important requirements for a safe working environment
- Easy transmission of available torque
- Long life of nut and bolt
- Profiles easy on the bolt heads (UD, jaw, hexagon)
- Minimum production tolerances ensure that spanners fit perfectly on bolts





WHY MATT CHROME-PLATED?

- Secure grip, even with oily hands
- Double corrosion protection



PRECISE
RELIABLE



DURABLE AND VERY RESILIENT

- For hard continuous use and safety in use
- High bending stiffness - bending instead of breaking or splintering when overloaded
- Extreme hardness for long service life

WIDEST RANGE

- Extremely wide range in standard, non-standard, metric (mm), imperial (AF) and Whitworth (W) dimensions.
- Available individually or in convenient sets or modules

GEDORE UNIT-DRIVE

The GEDORE UNIT-DRIVE profile prevents the "round turning" of screw heads by means of a wave profile without pointed or sharp edges.

TRADITIONAL PROFILE

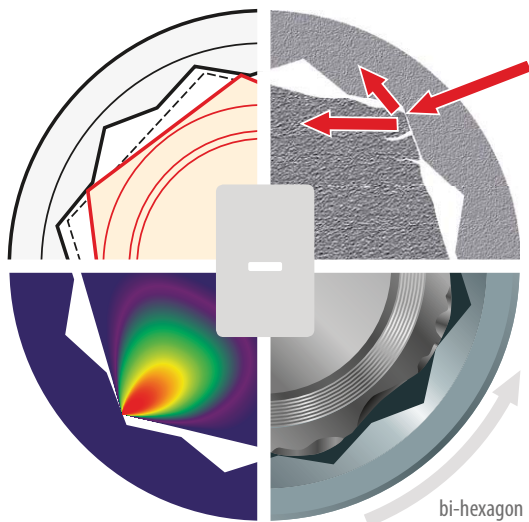

1 The reduced contact surface lessens the force closure. Certain torque transfer is no longer possible and can become a risk.

2 The influence exerted of the sharp edges raises the notching effect on the bolt. The profile is ruined.

3 Since there is no longer any torque transfer, the rounded bolt profiles cannot be unscrewed - the tool keeps on slipping.

4 Pronounced force on the tip of the bolt profile. Concentrated pressure deforms the bolt.

1 A large contact surface provides a secure force closure even for those bolts whose sizes lie outside of the tolerances.

2 Uniform distribution of the force on the bolt flanks. The resulting reduced notching effect stops the bolt from turning round and round.

3 Gentle torque transfer enables even worn bolts to be unscrewed with every certainty - no slipping of the tool at all.

4 Thanks to the optimally distributed force up to 20 % higher torques can be transferred.

GEDORE UNIT-DRIVE PROFILE (UD-PROFILE)

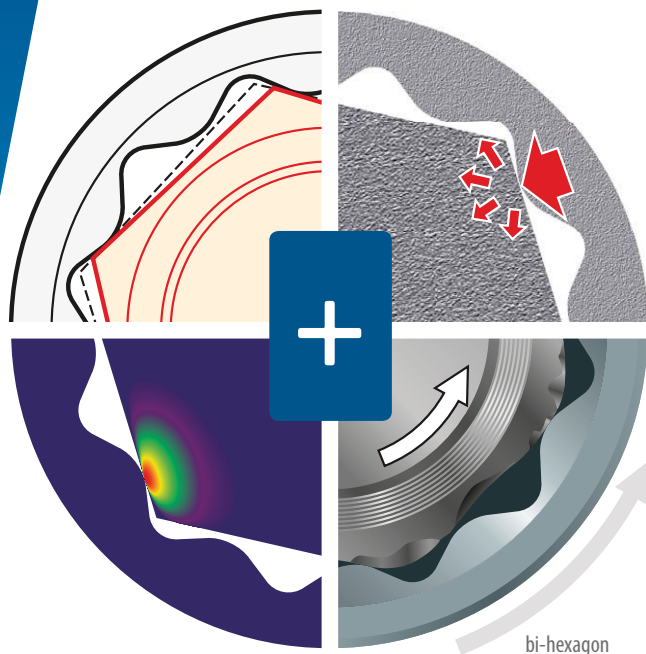

OPTIMUM FRICTIONAL LOCKING PROTECTS SCREW HEADS



Enlarged, round contact surfaces of GEDORE tools ensure reliable torque transmission, which acts evenly on the screw head.

The notch effect, reduced to a minimum as a result, prevents damage to the screw head profile - a plus for safety, as slipping and spinning is prevented, even with damaged screw heads.

i SPANNER RATCHET

The revolution

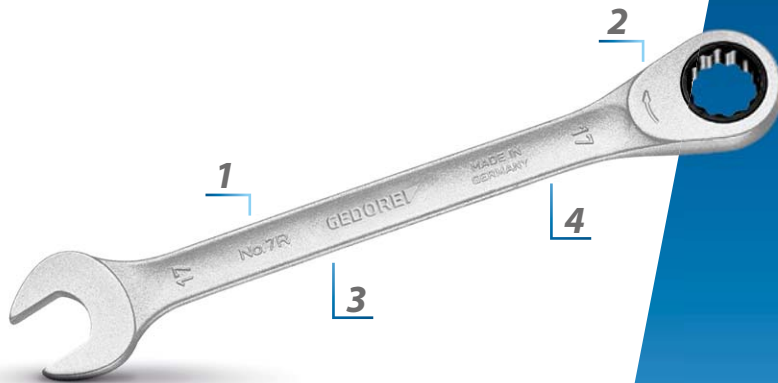

- 1** HOLLOW PROFILE
COMFORTABLE TO HOLD
- 2** FOR RATCHET LOOSENING
AND FAST TIGHTENING
- 3** WARP-RESISTANT GEOMETRY
WITH DOUBLE T-GIRDER EFFECT
- 4** NON-GLARE LOOK THANKS TO
MATT CHROME-PLATING

- With same size each end
- UD profile
- High torque transfer
- GEDORE vanadium steel 31CrV3
- Non-glare look thanks to matt chrome plating, locking insert and pawl manganese-phosphated

- Hot forged
- Jaw: ground precisely to exact nominal size for optimum contact areas
- In combination with adaptor no. 7 RA or 7 RB (please order separately) the spanner no. 7 R and 7 UR can be used as a (bit) ratchet

7 R

Combination ratchet spanner
Flat pattern

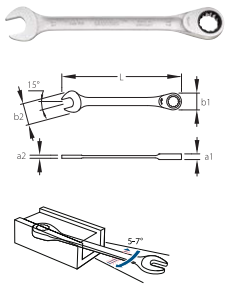

- > With same size each end
- > For ratcheting release or quick tightening
- > Flat pattern
- > High torque transfer

Code	No.	Ø mm	L	Code	No.	Ø mm	L
2297051	7 R 8	8,0	140	2297167	7 R 18	18,0	237
2297078	7 R 9	9,0	150	2297175	7 R 19	19,0	250
2297086	7 R 10	10	160	2219433	7 R 21	21,0	274
2297094	7 R 11	11	164	2297191	7 R 22	22,0	292
2297108	7 R 12	12,0	170	2297205	7 R 24	24,0	325
2297116	7 R 13	13,0	180	2297213	7 R 27	27,0	359
2297124	7 R 14	14,0	190	2297221	7 R 30	30,0	399
2297132	7 R 15	15,0	200	2297248	7 R 32	32,0	424
2297140	7 R 16	16,0	212	2219549	7 R 34	34,0	449
2297159	7 R 17	17,0	225	2219557	7 R 36	36,0	480

7 UR

Combination ratchet spanner, reversible

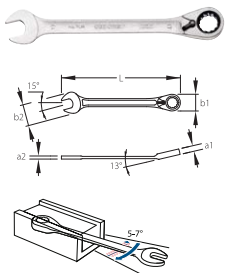

- > With same size each end
- > For ratchet loosening and fast tightening
- > Ring 13° offset from shaft, reversible
- > High torque transfer

Code	No.	Ø mm	L	Code	No.	Ø mm	L
2297256	7 UR 8	8,0	140	2297337	7 UR 16	16,0	212
2297264	7 UR 9	9,0	150	2297345	7 UR 17	17,0	225
2297272	7 UR 10	10,0	160	2297353	7 UR 18	18,0	237
2297280	7 UR 11	11,0	164	2297361	7 UR 19	19,0	250
2297299	7 UR 12	12,0	170	2244500	7 UR 21	21,0	274
2297302	7 UR 13	13,0	180	2297388	7 UR 22	22,0	292
2297310	7 UR 14	14,0	190	2297396	7 UR 24	24,0	325
2297329	7 UR 15	15,0	200				

Spanners

7 R-005

Combination ratchet spanner set
5 pieces

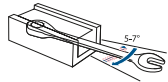

- > Practical composition
- > For ratchet loosening and fast tightening
- > Flat pattern
- > In plastic case

Code	No.	Contents	Pieces	
2297434	7 R-005	7 R 8 10 13 17 19 mm	5	0,932

7 R-012

Combination ratchet spanner set
12 pieces

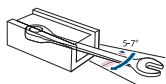

- > Practical composition
- > For ratchet loosening and fast tightening
- > Flat pattern
- > In robust sheet metal case

Code	No.	Contents	Pieces	
2297442	7 R-012	7 R 8 10 12 13 14 15 16 17 18 19 mm	12	2,84

7 UR-005

Combination ratchet spanner set, reversible
5 pieces



- > Practical composition
- > For ratchet loosening and fast tightening
- > Ring 13° offset from shaft, reversible
- > In plastic case

Code	No.	Contents	Pieces	
2327651	7 UR-005	7 UR 8 10 13 17 19 mm	5	0,93

7 UR-012

Combination ratchet spanner set, reversible
12 pieces



- > Practical composition
- > For ratchet loosening and fast tightening
- > Ring 13° offset from shaft, reversible
- > In robust sheet metal case

Code	No.	Contents	Pieces	
2297418	7 UR-012	7 UR 8 9 10 11 12 13 14 15 16 17 18 19 mm	12	2,84

7 RA

Adaptor for 7 R / 7 UR



- > The adaptor transforms the ring ratchet spanner into a ratchet
- > With push-button release, wear-resistant and manganese phosphated
- > Fast-turning ring for swift release or tightening
- > Secure adaptor fit in the ring ratchet thanks to circlip

Code	No.				H	
2320495	7 RA-6,3	10	1/4"	6,3	18	0,011
2320487	7 RA-10	13	3/8"	10,0	24	0,03
2320479	7 RA-12,5	19	1/2"	12,5	32	0,07

7 RB

Bit adaptor
for 7 R/7 UR



- > The adaptor transforms the ring ratchet spanner into a bit ratchet
- > Secure adaptor fit in the ring ratchet thanks retaining ball
- > With magnetic holder

Code	No.	mm	"	mm	H	kg
2329239	7 RB-6,3	10	1/4"	6,3	20,5	0,011
2327643	7 RB-8	10	5/16"	8,0	23	0,015

i NO. 1 B

The strong all-rounder



- 1** JAW: GROUND PRECISELY TO EXACT NOMINAL SIZE FOR OPTIMUM CONTACT AREAS
- 2** NON-GLARE LOOK THANKS TO MATT CHROME-PLATING
- 3** RING: 10° OFFSET FROM SHAFT, WITH UD PROFILE FOR GENTLE TRANSMISSION OF FORCE
- 4** SLIM RIBBED OPEN END FOR ADDED STRENGTH GUARANTEES MAXIMUM TORQUES

- Acc. to DIN 3113 Form B, ISO 3318, ISO 7738
- Sizes 5 and 5.5 mm with hexagonal ring, up from size 6 mm with UD profile
- GEDORE vanadium steel 31CrV3, chrome plated
- Carefully forged and professionally machined

- Ring: cranked and angled 10°, with UD Profi for gentle power transmission
- Overloading indicated by deformation
- The offset ring ensures a better grip on deep seated or inset nuts or bolts
- Top-grade industrial quality for the hardest of continuous use

1 B (MM)

Combination spanner
with same size each end
metric

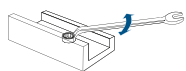
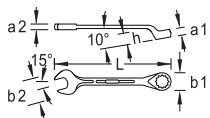

- > Size 5 and 5.5 mm with hexagonal ring, from 6 mm with UD profile for gentle power transmission
- > Ring cranked and angled 10°
- > For actuating recessed or deep-set nuts or screws

* not standardised

Code	No.	mm	L	Code	No.	mm	L
6000240	1 B 5	5	100	6002450*	1 B 25	25	328
6000320	1 B 5,5	5.5	100	6002530*	1 B 26	26	340
6000400	1 B 6	6	100	6002610	1 B 27	27	352
6000590	1 B 7	7	112	6002880*	1 B 28	28	370
6000670	1 B 8	8	125	6002960*	1 B 29	29	370
6000750	1 B 9	9	138	6003180	1 B 30	30	390
6000830	1 B 10	10	148	6003260	1 B 32	32	412
6000910	1 B 11	11	158	6003340*	1 B 33	33	412
6001050	1 B 12	12	168	6004150	1 B 34	34	412
6001130	1 B 13	13	185	6003420	1 B 36	36	460
6001210	1 B 14	14	198	6003500*	1 B 38	38	460
6001480	1 B 15	15	210	6003690	1 B 41	41	520
6001560	1 B 16	16	220	6003770	1 B 46	46	550
6001640	1 B 17	17	232	6003850	1 B 50	50	580
6001720	1 B 18	18	245	6003930	1 B 55	55	620
6001800	1 B 19	19	258	6004070	1 B 60	60	660
6001990*	1 B 20	20	270	6004660*	1 B 65	65	710
6002020	1 B 21	21	280	6004740*	1 B 70	70	760
6002100	1 B 22	22	292	6004820*	1 B 75	75	810
6002290*	1 B 23	23	305	6004900*	1 B 80	80	860
6002370	1 B 24	24	318				

Spanners

1 B (AF)

Combination spanner with same size each inch

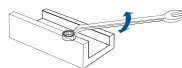
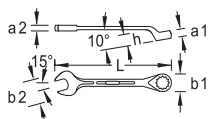

- > With UD profile for gentle power transmission, from SW 1.3/8" 12-edge ring
- > Ring cranked and angled 10
- > For actuating recessed or deep-set nuts or screws

Code	No.	AF	L	Code	No.	AF	L
6005120	1 B 1/4AF	1/4"	100	6006870	1 B 1.1/4AF	1.1/4"	412
6005200	1 B 5/16AF	5/16"	125	6006950	1 B 1.5/16AF	1.5/16"	412
6005390	1 B 3/8AF	3/8"	148	6007090	1 B 1.3/8AF	1.3/8"	460
6005470	1 B 7/16AF	7/16"	158	6007170	1 B 1.7/16AF	1.7/16"	460
6005550	1 B 1/2AF	1/2"	185	6007250	1 B 1.1/2AF	1.1/2"	460
6005630	1 B 9/16AF	9/16"	198	6007330	1 B 1.5/8AF	1.5/8"	520
6005710	1 B 5/8AF	5/8"	220	6007410	1 B 1.3/4AF	1.3/4"	550
6005980	1 B 11/16AF	11/16"	245	6007680	1 B 1.13/16AF	1.13/16"	550
6006010	1 B 3/4AF	3/4"	258	6007760	1 B 1.7/8AF	1.7/8"	550
6006280	1 B 13/16AF	13/16"	280	6007840	1 B 2AF	2"	580
6006360	1 B 7/8AF	7/8"	292	6007920	1 B 2.1/16AF	2.1/16"	580
6006440	1 B 15/16AF	15/16"	318	6008060	1 B 2.3/16AF	2.3/16"	620
6006520	1 B 1.AF	1"	340	6008140	1 B 2.1/4AF	2.1/4"	620
6006600	1 B 1.1/16AF	1.1/16"	352	6008220	1 B 2.3/8AF	2.3/8"	660
6006790	1 B 1.1/8AF	1.1/8"	370	6008300	1 B 2.7/16AF	2.7/16"	660

1 B (WW)

Combination spanner with same size each inch Whitworth

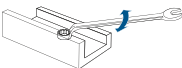
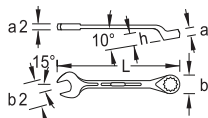

- > With 12-sided ring
- > Ring cranked and angled 10
- > For actuating recessed or deep-set nuts or screws

Code	No.	Whitw.	L	Code	No.	Whitw.	L
6009540	1 B 1/8W	1/8W	138	6010120	1 B 1/2W	1/2W	305
6009620	1 B 3/16W	3/16W	158	6010200	1 B 9/16W	9/16W	340
6009700	1 B 1/4W	1/4W	185	6010390	1 B 5/8W	5/8W	370
6009890	1 B 5/16W	5/16W	210	6010470	1 B 11/16W	11/16W	390
6009970	1 B 3/8W	3/8W	245	6010550	1 B 3/4W	3/4W	412
6010040	1 B 7/16W	7/16W	280				

1 B (MM) / 1 B (AF)

Combination spanner set metric

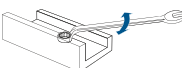
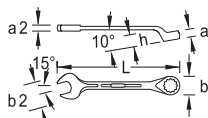

- > With UD profile for gentle power transmission, from SW 1.3/8" 12-edge ring
- > Ring cranked and angled 10
- > For actuating recessed or deep-set nuts or screws

Code	No.	Contents	pieces	
6011870	1 B-08	10 12 13 14 17 19 22 24 mm	8	2,6
6011950	1 B-080	8 9 10 11 13 14 17 19 mm	8	1
6013300	1 B-08A	3/8 7/16 1/2 9/16 5/8 3/4 7/8 1"	8	1,41
6012250	1 B-011	8 9 10 11 12 13 14 15 17 19 22 mm	11	1,19
6012170	1 B-012	10 11 12 13 14 17 19 22 24 27 30 32 mm	12	3,39
6012840	1 B-0112	6 7 8 9 10 11 12 13 14 15 17 19 mm	12	0,925
6013650	1 B-014A	5/16 3/8 7/16 1/2 9/16 5/8 11/16 3/4 13/16 7/8 1 1.1/16 1.1/8 1.1/4"	14	3,488
6000160	1 B-0115	6 7 8 9 10 11 12 13 17 19 22 24 27 30 32 mm	15	3,385
6012680	1 B-017	6 7 8 9 10 11 12 13 14 15 16 17 18 19 20 21 22 mm	17	2,3
6013060	1 B-020	8 9 10 11 12 13 14 15 16 17 18 19 21 22 23 24 26 27 30 32 mm	20	5,5
6012920	1 B-026	6 7 8 9 10 11 12 13 14 15 16 17 18 19 20 21 22 23 24 25 26 27 28 29 30 32 mm	26	7,5

i NO. 7

The handy

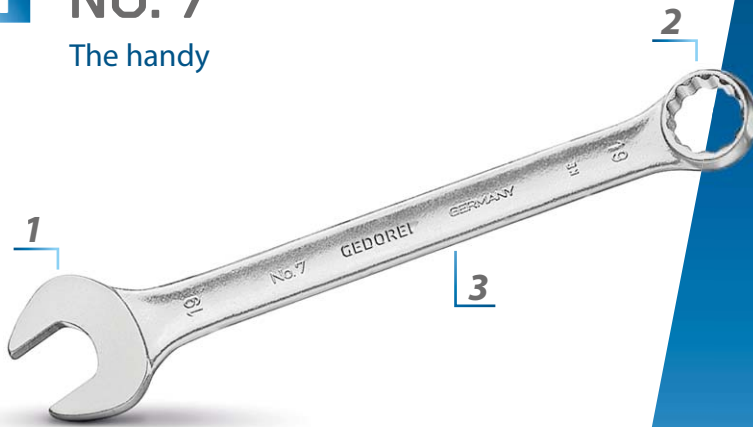

1 JAW: GROUND PRECISELY TO EXACT NOMINAL SIZE FOR OPTIMUM CONTACT AREAS

2 RING: 15° OFFSET FROM SHAFT, WITH UD PROFILE FOR GENTLE TRANSMISSION OF FORCE

3 NON-GLARE LOOK THANKS TO MATT CHROME-PLATING

- Acc. to DIN 3113 Form A, ISO 3318, ISO 7738
- GEDORE vanadium steel 31CrV3, chrome plated
- Carefully forged and professionally machined
- Slim jaw and jaw walls make this spanner lighter overall
- Overloading indicated by deformation

- Secure grip thanks to hollow shaft - very ergonomic and handy
- Non-glare look thanks to matt chrome-plating
- Designed for universal use
- Top-grade industrial quality for the hardest of continuous use

7 (MM)

Combination spanner with same size each end metric

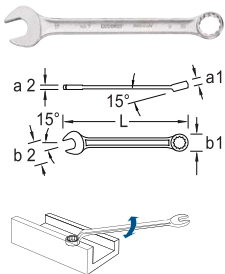

- > Slim jaw and jaw walls make this spanner lighter overall
- > Ring 15° angled, with UD profile - for gentle power transmission
- > Mouth position 15°, precisely ground to exact nominal dimension for optimum contact surfaces

* not standardised

Code	No.	Ø mm	L	Code	No.	Ø mm	L
6080680*	7 3	3	78	6090720	7 17	17	210
6080760*	7 3,2	3.2	78	6091880	7 18	18	220
6080840*	7 3,5	3.5	78	6090800	7 19	19	230
6080920*	7 4	4	85	6091960*	7 20	20	240
6081060*	7 4,5	4.5	85	6092180	7 21	21	252
6081140*	7 5	5	92	6090990	7 22	22	262
6081220*	7 5,5	5.5	92	6092260*	7 23	23	270
6089550	7 6	6	100	6091020	7 24	24	282
6089630	7 7	7	110	6092340*	7 25	25	290
6089710	7 8	8	120	6092420*	7 26	26	302
6089980	7 9	9	130	6091100	7 27	27	310
6090050	7 10	10	140	6092500*	7 28	28	320
6090130	7 11	11	150	6092690*	7 29	29	330
6090210	7 12	12	160	6091290	7 30	30	340
6090480	7 13	13	170	6091370	7 32	32	370
6090560	7 14	14	180	1827987	7 34	34	420
6090640	7 15	15	190	6089470	7 36	36	460
6091610	7 16	16	200				

WWW.GEDORE.COM

Spanners

7 (AF)

Combination spanner with same size each inch

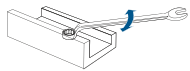
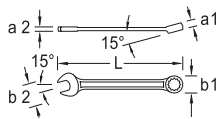

- > Slim jaw and jaw walls make this spanner lighter overall
- > Ring 15° angled, with UD profile - for gentle power transmission
- > Mouth position 15°, precisely ground to exact nominal dimension for optimum contact surfaces

Code	No.	⌀ "AF"	L	Code	No.	⌀ "AF"	L
1436767	7 3/16AF	3/16"	85	6099510	7 9/16AF	9/16"	180
1436775	7 7/32AF	7/32"	92	6099780	7 5/8AF	5/8"	200
6098700	7 1/4AF	1/4"	100	6099860	7 11/16AF	11/16"	220
6098890	7 5/16AF	5/16"	120	6099940	7 3/4AF	3/4"	230
6098970	7 11/32AF	11/32"	130	6100030	7 13/16AF	13/16"	252
6099190	7 3/8AF	3/8"	140	6100110	7 7/8AF	7/8"	262
6099270	7 7/16AF	7/16"	150	6100380	7 15/16AF	15/16"	282
6099430	7 1/2AF	1/2"	170	6100460	7 1AF	1"	302

7 XL

Combination spanner extra long

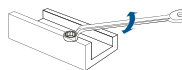
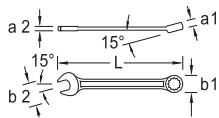

- > With same size each end
- > Extra long shaft for deep range of use and more torque
- > Slim jaw and jaw walls make this spanner lighter overall
- > Ring 15° angled, with UD profile - for gentle power transmission
- > Mouth position 15°, precisely ground to exact nominal dimension for optimum contact surfaces

Code	No.	⌀ mm	L	Code	No.	⌀ mm	L
1394916	7 XL 7	7	160	6101000	7 XL 19	19	310
6080090	7 XL 8	8	170	6080410	7 XL 21	21	340
6080170	7 XL 9	9	180	6101190	7 XL 22	22	350
6097300	7 XL 10	10	190	6101270	7 XL 24	24	400
6097490	7 XL 11	11	200	6101350	7 XL 27	27	450
6100540	7 XL 12	12	210	6101780	7 XL 30	30	480
6100620	7 XL 13	13	225	6101430	7 XL 32	32	500
6100700	7 XL 14	14	235	6101940	7 XL 34	34	520
6100890	7 XL 15	15	250	6101510	7 XL 36	36	550
6080250	7 XL 16	16	265	6102080	7 XL 41	41	600
6100970	7 XL 17	17	280	6102160	7 XL 46	46	640
6080330	7 XL 18	18	295				

7 XL

Combination spanner set extra long





- > With same size each end
- > Extra long shaft for deep range of use and more torque
- > Slim jaw and jaw walls make this spanner lighter overall
- > Ring 15° angled, with UD profile - for easy power transmission
- > Mouth position 15°, precisely ground to exact nominal dimension for optimum contact surfaces

Code	No.	Contents	pieces	kg
6104880	7 XL-080	8 9 10 11 13 14 17 19 mm	8	0,962
6104960	7 XL-0111	8 10 11 12 13 14 16 17 18 19 22 mm	11	1,794
6095950	7 XL-012	10 11 12 13 14 17 19 22 24 27 30 32 mm	12	4,41

7 (MM) / 7 (AF)Combination
spanner set
metric

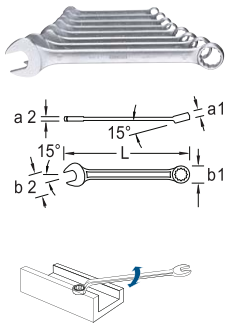
- > Practical composition
- > With same size each end
- > Ring 15° angled, with UD profile - for gentle power transmission
- > Mouth position 15°, precisely ground to exact nominal dimension for optimum contact surfaces



Code	No.	Contents	pieces	
6092770	7-08	10 12 13 14 17 19 22 24 mm	8	0,973
6092850	7-080	8 9 10 11 13 14 17 19 mm	8	0,536
6091450	7-08A	3/8 7/16 1/2 9/16 5/8 3/4 7/8 1"	8	1,047
6093070	7-011	8 9 10 11 12 13 14 15 17 19 22 mm	11	0,868
6091530	7-0112	6 7 8 9 10 11 12 13 14 15 17 19 mm	12	0,686
6093150	7-012	10 11 12 13 14 17 19 22 24 27 30 32 mm	12	2,7
6093580	7-017	6 7 8 9 10 11 12 13 14 15 16 17 18 19 20 21 22 mm	17	1,465
6093660	7-020	8 9 10 11 12 13 14 15 16 17 18 19 21 22 23 24 26 27 30 32 mm	20	3,36
6093740	7-026	6 7 8 9 10 11 12 13 14 15 16 17 18 19 20 21 22 23 24 25 26 27 28 29 30 32 mm	26	4,665

i NO. 4 R



The double with ratchet

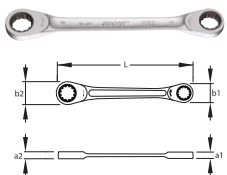

- Flat pattern
- Thin walled rings
- UD profile
- Working angle: 7° up to 14x15 mm, 6° from 16x17 mm to 18x19 mm
- For ratchet loosening and fast tightening
- GEDORE vanadium steel 31CrV3
- Non-glare look thanks to matt chrome plating, locking insert and pawl manganese phosphated
- Hot forged
- Tried-and-tested GEDORE technology combined anew: stable hollow shaft of no. 7 and refined mechanism of the U-20 ratchets
- In combination with adaptor no. 7 RA or 7 RB (please order separately) the spanner no. 4 R can be used as a (bit) ratchet

4 R (MM)Double ring ratchet
spanner

- > With different key widths
- > Flat pattern
- > Thin walled rings
- > For ratchet loosening and fast tightening
- > With adaptor No. 7 RA or 7 RB (please order separately) the No. 4 R becomes a (bit) ratchet
- > Return angle 7° to 14x15 mm, 6° 16x17 mm to 18x19 mm

Code	No.	 mm	L	
2306719	4 R 8X9	8 x 9	134	0,04
2306743	4 R 10X11	10 x 11	153,5	0,07
2306751	4 R 10X13	10 x 13	165,5	0,08
2306786	4 R 12X13	12 x 13	174,5	0,09
2306794	4 R 14X15	14 x 15	197	0,14
2306816	4 R 17X19	17 x 19	235	0,22
2306832	4 R 18X19	18 x 19	248	0,23

2

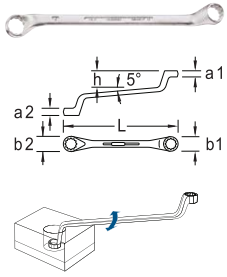
Double ended ring
spanner

- > With different key widths
- > Rings deeply cranked and angled at 5°
- > For extremely deep or inset bolts

* not standardised

Code	No.	Ø mm	L	Code	No.	Ø mm	L
6010630*	2 5,5X7	5.5x7	170	6018020*	2 21X23	21x23	305
6015350	2 6X7	6x7	170	6018100	2 22X24	22x24	307
6015430	2 7X8	7x8	180	6018370*	2 24X26	24x26	325
6015510	2 8X9	8x9	182	6018450	2 24X27	24x27	325
6015780	2 8X10	8x10	182	6018530	2 24X30	24x30	345
6015860*	2 9X11	9x11	195	6018610*	2 25X28	25x28	345
6015940	2 10X11	10x11	195	6018880*	2 27X29	27x29	345
6016080*	2 10X12	10x12	195	6018960	2 27X30	27x30	345
6016160	2 10X13	10x13	212	6019180	2 27X32	27x32	370
6016320	2 11X13	11x13	212	6019260	2 30X32	30x32	370
6016590	2 12X13	12x13	212	6019340	2 30X36	30x36	400
6016670	2 12X14	12x14	212	6019420	2 32X36	32x36	400
6016750	2 13X14	13x14	225	6019500	2 36X41	36x41	440
6016830	2 13X15	13x15	225	6019690*	2 38X42	38x42	440
6016910	2 14X15	14x15	225	6019770	2 41X46	41x46	485
6017050	2 13X17	13x17	245	6019850	2 46X50	46x50	535
6017130	2 14X17	14x17	245	6019930*	2 55X60	55x60	610
6017210	2 16X17	16x17	245	6025660	2 16X18	16x18	265
6017480	2 17X19	17x19	265	6025740	2 18X21	18x21	285
6017560	2 18X19	18x19	265	6025820	2 21X24	21x24	307
6017720	2 19X22	19x22	287	6025900	2 30X34	30x34	375
6017800*	2 20X22	20x22	287	6026040	2 34X36	34x36	420
6017990	2 19X24	19x24	305				

i NO. 2

Offset



- Rings deep offset, strong but thin walls
- Acc. to DIN 838, ISO 3318, ISO 1085, ISO 10104
- GEDORE vanadium steel 31CrV3, chrome plated * not standardised
- Carefully forged and professionally machined:
- Ring: thin-walled, 5° deep offset from shaft, with UD profile for gentle transmission of force
- High bending strength - does not fracture or splinter when overloaded, thus minimising the risk of injury
- Overloading indicated by deformation
- Non-glare look thanks to matt chrome-plating
- Specialist for extremely deep or inset bolts
- Top-grade industrial quality for the hardest of continuous use

2

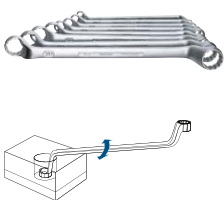
Double ended ring
spanner set

- > Practical composition
- > With different key widths
- > Rings deeply cranked and angled at 5°

Code	No.	Contents	Pieces	kg
6030580	2-8	6x7 8x9 10x11 12x13 14x15 16x17 18x19 20x22 mm	8	1,297
6030740	2-10	6x7 8x9 10x11 12x13 14x15 16x17 18x19 20x22 21x23 24x27 mm	10	2,225
6031120	2-100	6x7 8x9 10x11 12x13 14x15 16x17 18x19 20x22 24x27 30x32 mm	10	2,555
6030900	2-12	6x7 8x9 10x11 12x13 14x15 16x17 18x19 20x22 21x23 24x26 25x28 27x32 mm	12	4,06
6031040	2-120	6x7 8x9 10x11 12x13 14x15 16x17 18x19 20x22 21x23 24x27 25x28 30x32 mm	12	4
6031390	2-122 ISO	6x7 8x9 10x11 12x13 14x15 16x18 17x19 20x22 21x23 24x26 27x32 30x34 mm	12	3,73

4

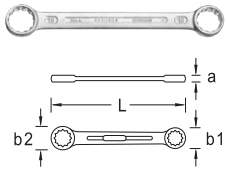
Double ended
ring spanner
straight

- > With different key widths
- > Flat pattern
- > Thin walled rings

* not standardised

Code	No.	mm	L	kg
6052710	4 6X7	6x7	99	0,014
6053010	4 8X9	8x9	114	0,024
6053280	4 8X10	8x10	115	0,022
6053440	4 10X11	10x11	131	0,034
6053520	4 10X13	10x13	149	0,045
6053870	4 12X13	12x13	149	0,049
6054170	4 13X15	13x15	161	0,064
6054250	4 14X15	14x15	161	0,064
6054330	4 13X17	13x17	167	0,074
6054410	4 14X17	14x17	169	0,077
6054680	4 16X17	16x17	169	0,084
6054760	4 17X19	17x19	186	0,098
6054840	4 18X19	18x19	186	0,106
6054920	4 19X22	19x22	209	0,136
6055060*	4 20X22	20x22	209	0,134
6055140*	4 19X24	19x24	233	0,176
6055220*	4 21X23	21x23	233	0,171
6055300	4 22X24	22x24	233	0,184
6055490*	4 24X26	24x26	261	0,23
6055570	4 24X27	24x27	260	0,249
6055650	4 24X30	24x30	290	0,303
6055730*	4 25X28	25x28	289	0,273
6055810	4 27X32	27x32	320	0,373
6056030	4 30X32	30x32	320	0,399
6056110	4 30X36	30x36	357	0,469
6056380	4 32X36	32x36	357	0,492
6056460	4 36X41	36x41	391	0,616
6056540	4 41X46	41x46	431	0,789
6056620	4 46X50	46x50	473	1,035

4

Double ended ring
spanner set

- > Practical composition
- > With different key widths
- > Flat pattern
- > Thin walled rings

Code	No.	Contents	Pieces	kg
6061700	4-8	6x7 8x9 10x11 12x13 14x15 16x17 18x19 20x22 mm	8	0,521
6062000	4-12	6x7 8x9 10x11 12x13 14x15 16x17 18x19 20x22 21x23 24x26 25x28 27x32 mm	12	1,549
6062190	4-120	6x7 8x9 10x11 12x13 14x15 16x17 18x19 20x22 21x23 24x27 25x28 30x32 mm	12	2

TX 4

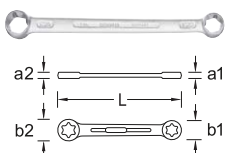
Double ended ring spanner
straight, for external TX

- > With different key widths

Code	No.	mm	L	kg
6059800	TX 4 E6XE8	5,74 x 7,52 mm	110	0,014
6059990	TX 4 E10XE12	9,42 x 11,17 mm	140	0,039
6060140	TX 4 E14XE18	12,90 x 16,70 mm	180	0,074
6060220	TX 4 E20XE24	18,45 x 22,16 mm	226	0,163

i SPECIAL



- Thin walled rings
- GEDORE vanadium steel 31CrV3, chrome plated
- Specialists in tight spaces

304 (MM)

Half-moon ring spanner

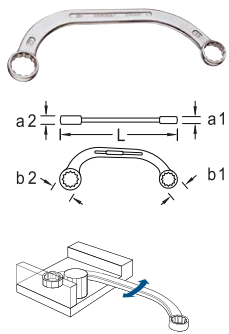

- > Thin walled rings
- > For working in extremely difficult to access areas

Code	No.	Ø mm	L	kg
6470040	304 11X13	11x13	150	0,077
6470120	304 13X17	13x17	185	0,14
6470200	304 14X16	14x16	185	0,137
6470390	304 14X17	14x17	185	0,144
6470470	304 15X17	15x17	185	0,15
6470550	304 19X22	19x22	230	0,261
6470630	304 13X15	13x15	185	0,129
6567550	304 16X18	16x18	185	0,163

400 (MM)

Double ended ring spanner open

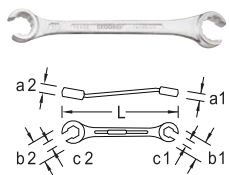

- > With different key widths
- > Application on hydraulic/brake lines
- > Sizes 8x10 to 12x14 mm with hexagon
- > Heads 15° angled
- > hexagonal opening 30° offset, UD profile opening 15° offset

* not standardised

Code	No.	Ø mm	L	kg
6057190	400 8X10	8x10	140	0,045
6056970*	400 9X11	9x11	145	0,059
6057270	400 10X11	10x11	150	0,064
6051070*	400 10X12	10x12	150	0,073
6057350	400 11X13	11x13	160	0,077
6057430	400 12X14	12x14	170	0,106
6057000*	400 13X15	13x15	180	0,116
6057510	400 14X17	14x17	195	0,136
6057780	400 17X19	17x19	210	0,179
6058670	400 19X22	19x22	230	0,246
6057860	400 22X24	22x24	250	0,335
6058750	400 24X27	24x27	270	0,408
6058830	400 30X32	30x32	300	0,575
1933175*	400 36X41	36x41	351	0,98
2297183*	400 46X50	46x50	396	0,8

i NO. 6

Strong and accurate

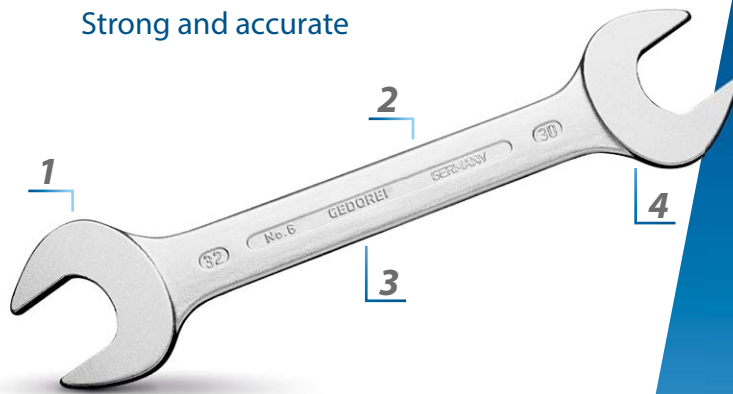

- Acc. to DIN 3110, ISO 3318, ISO 1085, ISO 10102
- Top-grade industrial quality for the hardest of continuous use
- Overloading indicated by deformation
- GEDORE vanadium steel 31CrV3, heads finely polished, chrome-plated

1 JAW: GROUND PRECISELY TO EXACT NOMINAL SIZE FOR OPTIMUM CONTACT AREAS

2 NON-GLARE LOOK THANKS TO MATT CHROME-PLATING

3 SECURE GRIP THANKS TO SLIM PROFILE SHAFT

4 SLIM PATTERN

6 (MM)

Double open ended spanner metric

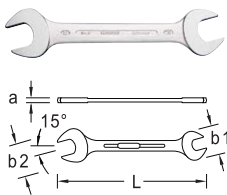

- > With different key widths
- > For hard to reach places thanks to very flat head

* not standardised

Code	No.	⌀mm	L	Code	No.	⌀mm	L
2312107*	6 55X60	55x60	560	6066500	6 18X19	18x19	222
6063400*	6 4X4,5	4x4.5	100	6066690*	6 17X22	17x22	236
6063590*	6 4X5	4x5	100	6066770	6 19X22	19x22	236
6063670*	6 5X5,5	5x5.5	100	6066850*	6 20X22	20x22	236
6063750*	6 5,5X7	5.5x7	122	6066930	6 19X24	19x24	250
6063830	6 6X7	6x7	122	6067070*	6 21X23	21x23	247
6063910*	6 6X8	6x8	122	6067150	6 22X24	22x24	250
6064050	6 7X8	7x8	140	6067230*	6 22X27	22x27	266
6064130*	6 7X9	7x9	140	6067310*	6 24X26	24x26	266
6064210	6 8X9	8x9	140	6067580	6 24X27	24x27	266
6064480	6 8X10	8x10	140	6067660	6 24X30	24x30	280
6064560*	6 9X10	9x10	157	6067740*	6 25X28	25x28	280
6064640*	6 9X11	9x11	157	6067820*	6 27X29	27x29	302
6064720	6 10X11	10x11	157	6067900	6 27X30	27x30	302
6064800*	6 10X12	10x12	157	6068040	6 27X32	27x32	302
6064990	6 10X13	10x13	172	6068120	6 30X32	30x32	302
6065100	6 11X13	11x13	172	6068200	6 30X36	30x36	328
6065290*	6 11X14	11x14	172	6068390	6 32X36	32x36	328
6065370	6 12X13	12x13	172	6068470	6 36X41	36x41	360
6065450	6 12X14	12x14	172	6068550*	6 38X42	38x42	360
6065530	6 13X14	13x14	178	6068630	6 41X46	41x46	400
6065610	6 13X15	13x15	188	6068710	6 46X50	46x50	450
6065880	6 14X15	14x15	188	6068980	6 13X16	13x16	190
6065960	6 13X17	13x17	205	6069360	6 18X21	18x21	236
6066180	6 14X17	14x17	205	6069440	6 21X24	21x24	250
6066260	6 16X17	16x17	205	6069520	6 30X34	30x34	302
6066340	6 16X18	16x18	205	6069600	6 34X36	34x36	328
6066420	6 17X19	17x19	222				

Spanners

6 (AF)

Double open ended spanner inch

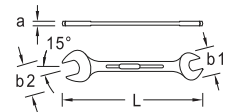

- > With different key widths
- > For hard to reach places thanks to very flat head

Code	No.	AF	L
6070020	6 1/4X5/16AF	1/4"x5/16"	122
6070100	6 5/16X3/8AF	5/16"x3/8"	140
6070290	6 3/8X7/16AF	3/8"x7/16"	157
6070370	6 7/16X1/2AF	7/16"x1/2"	172
6070450	6 1/2X9/16AF	1/2"x9/16"	190
6070530	6 9/16X5/8AF	9/16"x5/8"	190
6070610	6 19/32X11/16AF	19/32"x11/16"	205
6070880	6 5/8X11/16AF	5/8"x11/16"	205
6070960	6 5/8X3/4AF	5/8"x3/4"	222
6071260	6 3/4X25/32AF	3/4"x25/32"	222
6071340	6 3/4X7/8AF	3/4"x7/8"	236
6071420	6 25/32X13/16AF	25/32"x13/16"	236
6071500	6 13/16X7/8AF	13/16"x7/8"	236
6071690	6 7/8X15/16AF	7/8"x15/16"	250
6071770	6 15/16X1AF	15/16"x1"	266
6071930	6 1.X1.1/8AF	1"x1.1/8"	280
6072070	6 1.1/16X1.1/8AF	1.1/16"x1.1/8"	302
6072150	6 1.1/16X1.1/4AF	1.1/16"x1.1/4"	302
6072230	6 1.1/8X1.5/16AF	1.1/8"x1.5/16"	302
6072310	6 1.3/16X1.5/16AF	1.3/16"x1.5/16"	302
6072580	6 1.1/4X1.3/8AF	1.1/4"x1.3/8"	328
6072820	6 1.3/8X1.1/2AF	1.3/8"x1.1/2"	328
6073550	6 7/8X1.1/16AF	7/8"x1.1/16"	266

6 (MM)

Double open ended spanner set

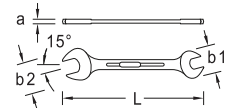

- > Practical composition
- > With different key widths
- > For hard to reach places thanks to very flat head

Code	No.	Contents	Pieces	
6077380	6-8	6x7 8x9 10x11 12x13 14x15 16x17 18x19 20x22 mm	8	0,819
6079400	H6-8	6x7 8x9 10x11 12x13 14x15 16x17 18x19 20x22 mm	8	0,995
6077540	6-10	6x7 8x9 10x11 12x13 14x15 16x17 18x19 20x22 21x23 24x27 mm	10	1,412
6077620	6-100	6x7 8x9 10x11 12x13 14x15 16x17 18x19 20x22 24x27 30x32 mm	10	1,66
6077700	6-12	6x7 8x9 10x11 12x13 14x15 16x17 18x19 20x22 21x23 24x26 25x28 27x32 mm	12	2,5
6077890	6-120	6x7 8x9 10x11 12x13 14x15 16x17 18x19 20x22 21x23 24x27 25x28 30x32 mm	12	2,52
6078350	6-122 ISO	6x7 8x9 10x11 12x13 14x15 16x18 17x19 20x22 21x23 24x26 27x32 30x34 mm	12	2,383
6079750	H6-120	6x7 8x9 10x11 12x13 14x15 16x17 18x19 20x22 21x23 24x27 25x28 30x32 mm	12	2,645

8 (MM)

Double open ended spanner small

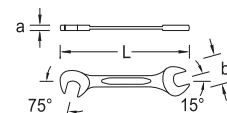

- > Small version
- > With same size each end
- > Jaw set at 15° and 75°

Code	No.	mm	L	Code	No.	mm	L
6093900	8 4	4x4	69	6094630	8 9	9x9	103,8
6094040	8 4,5	4.5x4.5	69	6094710	8 10	10x10	103,8
6094120	8 5	5x5	77,3	6094980	8 11	11x11	115,2
6094200	8 5,5	5.5x5.5	77,3	6095010	8 12	12x12	115,2
6094390	8 6	6x6	77,3	6095280	8 13	13x13	130,5
6094470	8 7	7x7	89,5	6095360	8 14	14x14	130,5
6094550	8 8	8x8	95,5				

8-011

Double open ended spanner set
11 pieces

- > With same size each end
- > Jaw set at 15° and 75°
- > In plastic case



Code	No.	Contents	Pieces	
1879146	8-011	4,5 5,5 6 7 8 9 10 11 12 13 mm	11	0,28

8-0100

Double open ended spanner set
10 pieces

- > With same size each end
- > Jaw set at 15° and 75°
- > In plastic bag



Code	No.	Contents	Pieces	
6099000	8-0100	5,5 6 7 8 9 10 11 12 13 mm	10	0,225

i NO. 895 UND NO. 894

The single in doubles and the single



- Carefully forged and professionally machined
- Jaw: ground precisely to exact nominal size for optimum contact areas
- Overloading indicated by deformation
- Secure grip thanks to profile shaft - very ergonomic and handy
- Jaw set at 15°
- GEDORE vanadium steel 31CrV3

895

Double open ended spanner
metric

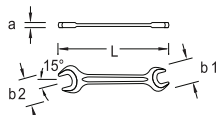

- > Manganese phosphate finish up to 34x36 mm, steel-grey up from 36x41 mm
- > Jaw set at 15°

*** not standardised**

Code	No.		L	Code	No.		L
6583080	895 34X36	34x36	320	6586340	895 17X19	17x19	171
6583910	895 7X8	7x8	107	6586420*	895 17X22	17x22	192
6584130	895 8X9	8x9	108	6586500*	895 18X19	18x19	171
6584640*	895 9X11	9x11	122	6587150*	895 22X27	22x27	233
6584720	895 10X11	10x11	124	6587230	895 24X27	24x27	246
6584990	895 10X13	10x13	128	6587580	895 24X30	24x30	269
6585100	895 11X13	11x13	140	6587740	895 27X32	27x32	275
6585370*	895 12X13	12x13	140	6587820	895 30X32	30x32	278
6585450	895 12X14	12x14	140	6587900	895 30X36	30x36	306
6585880*	895 14X15	14x15	154	6588040	895 32X36	32x36	310
6586180	895 14X17	14x17	158	6588120	895 36X41	36x41	347
6586260*	895 16X17	16x17	158	6588200	895 41X46	41x46	383

Spanners

894 (MM) / (AF)

Single open ended spanner metric

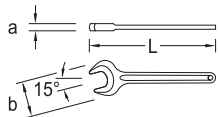

> Jaw set at 15°

* not standardised

Code	No.	mm	"AF	L	Code	No.	mm	"AF	L
6573600	894 6	6		73	6577350	894 60	60		494
6573790	894 7	7		78	6577430	894 65	65		528
6573870	894 8	8		94	6577510	894 70	70		572
6573950	894 9	9		100	6577780	894 75	75		610
6574090	894 10	10		106	6577860	894 80	80		645
6574170	894 11	11		112	6577940	894 85	85		690
6574250	894 12	12		124	6578080*	894 90	90		690
6574330	894 13	13		132	6578160*	894 95	95		847
6574410	894 14	14		140	6578240*	894 100	100		847
6574680	894 15	15		145	6578320*	894 105	105		1.000
6574760	894 16	16		155	6578400*	894 110	110		1.000
6574840	894 17	17		159	6578590*	894 115	115		1.000
6575220	894 18	18		165	6578670*	894 120	120		1.000
6575060	894 19	19		170	6576030*	894 125	125		1.000
6575300	894 22	22		193	6576110*	894 130	130		1.000
6575570	894 24	24		217	6576460*	894 135	135		1.000
6575650*	894 25	25		217	6579720	894 3/8AF		3/8"	100
6575810	894 27	27		239	6579990	894 7/16AF		7/16"	112
6576380	894 30	30		263	6580140	894 9/16AF		9/16"	140
6576540	894 32	32		275	6580300	894 5/8AF		5/8"	155
6575730	894 34	34		290	6580570	894 3/4AF		3/4"	170
6576700	894 36	36		305	6580730	894 13/16AF		13/16"	170
6576890*	894 38	38		305	6580810	894 7/8AF		7/8"	193
6576970	894 41	41		344	6581030	894 15/16AF		15/16"	217
6577000	894 46	46		380	6581380	894 1.1/16AF		1.1/16"	239
6577190	894 50	50		413	6581460	894 1.1/8AF		1.1/8"	239
6577270	894 55	55		459					

60 CP

Single open ended spanner adjustable, chromed

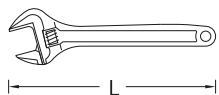

> Swedish pattern, roller with left hand thread
> Jaw set at 15°
> With adjusting scale

Code	No.	Size "	L	mm	"inch	kg
6380990	60 CP 6	6	155	20	25/32	0,145
6381020	60 CP 8	8	205	25	1	0,27
6381100	60 CP 10	10	255	30	1.3/16	0,42
6381290	60 CP 12	12	305	36	1.7/16	0,785

60 P

Single open ended spanner adjustable, 6°

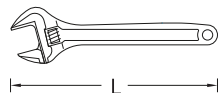

> Swedish pattern, roller with left hand thread
> Jaw set at 15°
> With adjusting scale

Code	No.	Size "	L	mm	"inch	kg
6380560	60 P 6	6	155	20	25/32	0,145
6380640	60 P 8	8	205	25	1	0,295
6380720	60 P 10	10	255	30	1.3/16	0,43
6380800	60 P 12	12	305	36	1.7/16	0,705

62 P

Single open ended spanner adjustable, 6°

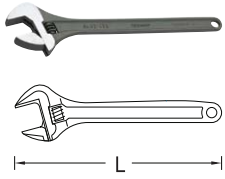

- > Swedish pattern, roller with left hand thread
- > Sturdy industrial design
- > Sizes 6" - 18" = ISO 6787, jaw position 15°
- > Size 24" = ISO 6787, jaw position 22.5°.

Code	No.	Size "	L	mm	"inch	
6368430	62 P 15	15	380	43	1.11/16	1,06
6368510	62 P 18	18	455	53	2.1/16	1,715
6360880	62 P 24	24	610	63	2.1/2	3,555

60 S

Single open ended spanner adjustable 0-30 mm

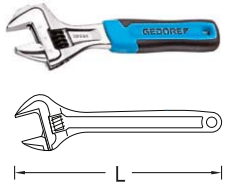

- > Swedish pattern, roller with left hand thread
- > Jaw set at 15°
- > With adjusting scale

Code	No.	Size "	L	mm	
2668815	60 S 6 P	6	153	20	0,16
1966294	60 S 8 P	8	206,5	25	0,34
2171023	60 S 10 P	10	254,5	30	0,251
2668823	60 S 6 JP	6	153	20	0,18
1966308	60 S 8 JP	8	206,5	25	0,36
2171015	60 S 10 JP	10	254,5	30	0,5
2668831	60 S 6 C	6	153	20	0,18
2668882	60 S 12 JP	12	305	36	0,86
2668890	60 S 12 C	12	305	36	0,78
1966316	60 S 8 C	8	206,5	25	0,34
2171007	60 S 10 JC	10	254,5	30	0,5
2170973	60 S 10 C	10	254,5	30	0,48
2668858	60 S 6 JC	6	153	20	0,18
1966324	60 S 8 JC	8	206,5	25	0,36
2668904	60 S 12 JC	12	305	36	0,86

NO. 2 A

The strong



- Heavy-duty pattern for highest torques
- GEDORE vanadium steel 31CrV3, chrome plated
- **Special sizes available on request**
- Optional accessories: No. 2 AR extension tube for extending the lever arm

**2 A**

Single ended ring spanner

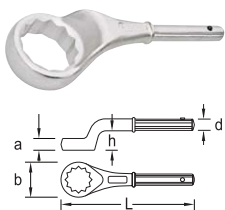

- > Heavy-duty pattern for highest torques
- > Special sizes available on request
- > Optional accessories: No. 2 AR extension tube for extending the lever arm

Code	No.	mm	L	Code	No.	mm	L
6033840	2 A 24	24	180	6034650	2 A 55	55	300
6033920	2 A 27	27	190	6034730	2 A 60	60	345
6034060	2 A 30	30	200	6034810	2 A 65	65	355
6034140	2 A 32	32	235	6035030	2 A 70	70	365
6030150	2 A 34	34	235	6035110	2 A 75	75	375
6034220	2 A 36	36	245	6035380	2 A 80	80	385
6034300	2 A 41	41	265	6035460	2 A 85	85	385
6034490	2 A 46	46	280	6035540	2 A 90	90	410
6034570	2 A 50	50	290	6035620	2 A 95	95	410

Spanners

2 AR Extension-tube



- > For single ended ring spanner no. 2 A
- > Ideal for extending the lever arm and applying higher forces

Code	No.	Internal-Ø	Ø mm	↳ mm	kg
6048600	2 AR 0	19 mm	24-30	460	0,614
6048790	2 AR 1	22 mm	32-41	610	1,568
6048870	2 AR 2	25 mm	46-55	760	2,84
6048950	2 AR 3	30 mm	60-95	860	3,715

2 ATM Single ended ring spanner set



- > Heavy-duty pattern for highest torques
- > With push-on tubes No. 2 AR to extend the lever arm
- > With UD profile for easy power transmission; from SW 65 12-edge
- > Incl. wall board made of sheet steel and hook set

Code	No.	Contents	Pieces	kg
6049250	2 ATM	2 A 24 27 30 32 36 41 46 50 55 60 65 70 75 80 85 2 AR 0 1 2 3 Sheet steel board with hook set	19	53

i THE POWERFUL



- Top-grade industrial quality for the hardest of continuous use
- For very heavy-duty work
- Special sizes available on request up to size 250 mm

306 (MM) / 306 (AF) Ring logging spanner

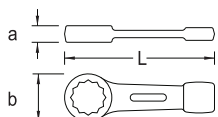

- > For heavy-duty work
- > Special sizes available on request

*** not standardised**

Code	No.	Ø mm	Ø "AF	L
1344331*	306 22	22		165
6475000*	306 24	24		160
6475190	306 27	27		180
6475270	306 30	30		190
6475350	306 32	32		195
6481670	306 34	34		195
6475430	306 36	36		205
6474460*	306 38	38		205
6475510	306 41	41		225
6475780	306 46	46		240
6475860	306 50	50		250
6475940	306 55	55		270
6476080	306 60	60		270
6476160	306 65	65		290

Code	No.	mm	"AF	L
6476240	306 70	70		320
6476320	306 75	75		325
6476400	306 80	80		345
6476590	306 85	85		360
6476670	306 90	90		400
6476750	306 95	95		400
6476830	306 100	100		400
6476910	306 105	105		435
6477050	306 110	110		435
6477130	306 115	115		435
6477210	306 120	120		480
6477480*	306 125	125		480
6477560	306 130	130		520
6477640	306 135	135		520
6474540	306 1.AF		1"	160
6474620	306 1.1/16AF		1.1/16"	180
6474700	306 1.1/8AF		1.1/8"	180
6474890	306 1.3/16AF		1.3/16"	190
6474970	306 1.1/4AF		1.1/4"	190
6478530	306 1.5/16AF		1.5/16"	195
6478610	306 1.3/8AF		1.3/8"	195
6478880	306 1.7/16AF		1.7/16"	205
6478960	306 1.1/2AF		1.1/2"	205
6479180	306 1.5/8AF		1.5/8"	225
6479260	306 1.11/16AF		1.11/16"	225
6479340	306 1.3/4AF		1.3/4"	225
6479420	306 1.13/16AF		1.13/16"	240
6479500	306 1.7/8AF		1.7/8"	240
6479690	306 2.AF		2"	250
6479770	306 2.1/16AF		2.1/16"	250
6479850	306 2.1/8AF		2.1/8"	250
6479930	306 2.3/16AF		2.3/16"	270
6480000	306 2.1/4AF		2.1/4"	270
6480190	306 2.3/8AF		2.3/8"	270
6480270	306 2.7/16AF		2.7/16"	270
6480350	306 2.9/16AF		2.9/16"	290
6480430	306 2.5/8AF		2.5/8"	290
6480510	306 2.3/4AF		2.3/4"	320
6480780	306 3.AF		3"	325

WWW.GEDORE.COM

Spanners

306 G Ring slogging spanner cranked

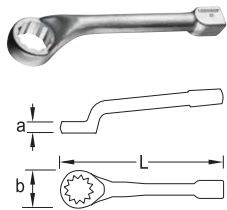

- > For heavy-duty work
- > for use with club hammer or pneumatic hammer for tightening or loosening

Code	No.	mm	L	Code	No.	mm	L
1415875	306 G 27	27	270	1416308	306 G 60	60	380
1415913	306 G 30	30	270	1416332	306 G 65	65	380
1415972	306 G 32	32	270	1416405	306 G 70	70	406
1416014	306 G 36	36	310	1416456	306 G 75	75	406
1416057	306 G 41	41	310	1416480	306 G 80	80	406
1416111	306 G 46	46	340	1416537	306 G 85	85	459
1416197	306 G 50	50	360	1416553	306 G 90	90	459
1416227	306 G 55	55	360	1416588	306 G 95	95	459

133 Open ended slogging spanner

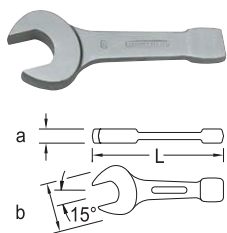

- > For heavy-duty work
- > Special sizes available on request

*** not standardised**

Code	No.	mm	L	Code	No.	mm	L
6410570	133 27	27	181	6401230	133 75	75	390
6400260	133 30	30	188	6401310	133 80	80	406
6400340	133 32	32	196	6401580	133 85	85	406
6411030	133 34	34	196	6401660	133 90	90	456
6400420	133 36	36	211	6401740	133 95	95	456
6400500	133 41	41	227	6401820	133 100	100	500
6400690	133 46	46	256	6401900	133 105	105	500
6400770	133 50	50	281	6402040	133 110	110	500
6400850	133 55	55	310	6402120	133 115	115	525
6400930	133 60	60	321	6402200	133 120	120	525
6401070	133 65	65	351	6402390*	133 125	125	545
6401150	133 70	70	370	6402470	133 130	130	575

308 Deep ring spanner straight

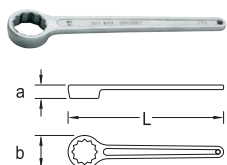

- > Especially suitable for locking screw connections
- > Special sizes available on request

*** not standardised**

Code	No.	mm	L	kg	Code	No.	mm	L	kg
6481750	308 32	32	265	0,358	6482130	308 50	50	400	1,23
6481830*	308 36	36	295	0,473	6482210	308 55	55	442	1,626
6481910	308 41	41	330	0,717	6482480	308 60	60	475	1,792
6482050	308 46	46	365	0,925	6482560*	308 65	65	510	2,208

i THE SPECIAL



- Opening at right angle to shaft for maximum accessibility
- GEDORE vanadium steel 31CrV3, chrome -plated

3114 Crowfoot spanner

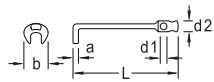

- > Angled open-end wrench for working in hard-to-reach areas
- > Delivery without pivot pin

Code	No.	Ø mm	L	26 D	kg
6670050	3114 13	13	160	8	0,095
6670130	3114 14	14	160	8	0,093
6676920	3114 16	16	200	10	0,16
6670210	3114 17	17	200	10	0,169
6677060	3114 18	18	200	12	0,216
6670480	3114 19	19	200	12	0,224
6677140	3114 21	21	200	12	0,272
6670560	3114 22	22	200	12	0,265
6670640	3114 24	24	250	14	0,419
6670720	3114 27	27	250	14	0,519
6670800	3114 30	30	250	16	0,633
6670990	3114 32	32	250	16	0,712
6671020	3114 36	36	315	18	1,034

26 D Tommy bar



- > Acc. to DIN 900 Form A
- > Chrome-vanadium steel 31CrV3, chrome-plated

Code	No.	Ø	L	kg	Code	No.	Ø	L	kg
6208580	26 D 6	6,00	157	0,04	6209040	26 D 14	14,00	316	0,386
6208740	26 D 8	8,00	177	0,073	6209120	26 D 16	16,00	396	0,634
6208820	26 D 10	10,00	197	0,127	6209200	26 D 18	18,00	495	0,995
6208900	26 D 12	12,00	246	0,228	6209390	26 D 20	20,00	625	1,555

534 Combination swivel head wrench

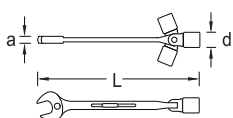

- > Slim pattern, with free moving socket wrench
- > With hole for tommy bars 26 D and 26 RS (please order separately)



Code	No.	Ø mm	L	26 D	26 RS	kg
6512060	534 10	10	179		1	0,071
6512140	534 11	11	189		1	0,087
6512220	534 12	12	198		1	0,115
6512300	534 13	13	208		1	0,14
6512490	534 14	14	218	6	1	0,151
6512570	534 15	15	231	6	1	0,169
6512650	534 16	16	244	6	1	0,222
6512730	534 17	17	255	8	2	0,237
6513030	534 18	18	269	8	2	0,273
6512810	534 19	19	283	8	2	0,304

Spanners

34 Swivel head wrench double ended

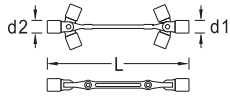

- > With different key widths
- > Thin walled heads, UD profile
- > Swivels through a wide radius
- > Shaft with holes for tommy bars 26 D and 26 RS (please order separately)

Code	No.	mm	L	26 D	26 RS	kg
6301520	34 6X7	6 x 7	190	6	1	0,089
6299010	34 8X9	8 x 9	200	6	1	0,098
6299280	34 10X11	10 x 11	205	6	1	0,11
6299360	34 12X13	12 x 13	240	8	2	0,204
6299600	34 13X17	13 x 17	275	10	2	0,318
6299520	34 14X15	14 x 15	245	8	2	0,216
6299870	34 16X17	16 x 17	280	10	2	0,334
6299950	34 17X19	17 x 19	315	12	3	0,411
6300040	34 18X19	18 x 19	315	12	3	0,418
6300120	34 20X22	20 x 22	350	12	3	0,604
6300200	34 21X23	21 x 23	350	12	3	0,633
6300390	34 24X27	24 x 27	410	14	3	0,913
6300470	34 30X32	30 x 32	470	14	3	1,361

IN 34 Swivel head wrench double ended for in-hex screws

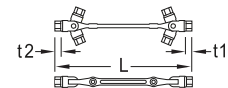

- > Swivels through a wide radius
- > Shaft with holes for tommy bars 26 D and 26 RS (please order separately)

Code	No.	mm	L	26 D	26 RS	kg
6302330	IN 34 5X6	5 x 6	202	6	1	0,107
6302680	IN 34 12X14	12 x 14	270	10	2	0,336
6302760	IN 34 17X19	17 x 19	295	12	3	0,411

25 Socket wrench offset

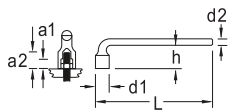

- > Solid design with particularly large head depth for protruding bolts, hexagonal
- > With dome for pointed screw heads

Code	No.	mm	L
6188290	25 10	10	160
6188530	25 13	13	200
6188880	25 17	17	250
6188960	25 19	19	280
6189340	25 27	27	380

25 V Socket wrench offset

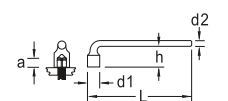

- > Solid design with particularly large head depth, square
- > Ideal for protruding bolts

Code	No.	mm	L
6194770	25 V 8	8	150
6194850	25 V 9	9	160
6194930	25 V 10	10	175
6195150	25 V 12	12	215
6195230	25 V 13	13	230
6195310	25 V 14	14	240
6195580	25 V 17	17	280

25 PK Tubular box spanner offset with hole

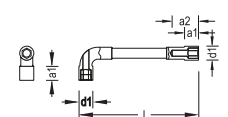

- > Solid pattern with two hexagon heads
- > Deep bores above the hexagon heads to take long studs
- > The rotary pin can also be used on the angled side (e.g. No. 26 D, please order separately)

Code	No.	mm	L	Code	No.	mm	L
1616323	25 PK 6	6	105	1436899	25 PK 17	17	187
1616331	25 PK 7	7	107	1436902	25 PK 18	18	195
1616358	25 PK 8	8	112	1436910	25 PK 19	19	205
1436805	25 PK 9	9	120	1436929	25 PK 21	21	225
1436813	25 PK 10	10	130	1436937	25 PK 22	22	225
1436821	25 PK 11	11	136	1436945	25 PK 24	24	248
1436848	25 PK 12	12	145	1436953	25 PK 27	27	280
1436856	25 PK 13	13	152	1436961	25 PK 30	30	310
1436864	25 PK 14	14	160	1436988	25 PK 32	32	330
1616366	25 PK 15	15	170	1436996	25 PK 34	34	340
1436872	25 PK 16	16	178	1437003	25 PK 36	36	355

25 PK-012Tubular box spanner set
12 pieces

- > Solid pattern with two hexagon heads
- > Deep bores above the hexagon heads to take long studs
- > The rotary pin can also be used on the angled side (e.g. No. 26 D, please order separately)

Code	No.	Contents	Pieces
1527312	25 PK-012	8 9 10 11 12 13 14 15 16 17 18 19 mm	12

626

Tubular box spanner

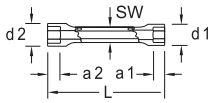

- > With hexagonal shaft
- > With through-holes for operation with open-ended spanner or rotary pin (No. 626 S / No. 26 RS-626 S)
- > Sizes 6x7 and 8x9 mm with no hole

Code	No.	mm	L	SW mm	26 RS-626 S
6525120	626 6X7	6 x 7	105	8,0	626 S 1
6525200	626 8X9	8 x 9	110	9,0	626 S 1
6525390	626 10X11	10 x 11	120	11,0	626 S 1
6525470	626 12X13	12 x 13	140	13,0	626 S 1
6520750	626 13X17	13 x 17	155	15,0	626 S 2
6525710	626 14X15	14 x 15	145	14,0	626 S 1
6526280	626 16X17	16 x 17	155	16,0	626 S 2
6526360	626 17X19	17 x 19	165	18,0	626 S 2
6526440	626 18X19	18 x 19	165	18,0	626 S 2
6526520	626 19X22	19 x 22	175	19,0	626 S 2
6526600	626 20X22	20 x 22	175	19,0	626 S 2
6526870	626 24X26	24 x 26	195	24,0	26 RS-626 S 3
6526950	626 24X27	24 x 27	195	24,0	26 RS-626 S 3
6527170	626 30X32	30 x 32	210	30,0	26 RS-626 S 3
6527250	626 32X36	32 x 36	225	32,0	26 RS-626 S 3

626 S

Stepped tommy bar



Code	No.	Ø 1	Ø 2	Ø 3	Ø 4	Ø 5	mm
6528060	626 S 1	3,70	4,70	5,20	7,00		190
6528140	626 S 2	6,70	7,70	8,70	9,70	11,00	240
6528220	26 RS-626 S-3	11,70	13,70	16,00			310

KD 626

Tubular box spanner set



- > Practical assembly of double socket wrenches with rotary pins
- > Similar to DIN 896, Form A, ISO 2236, ISO 1085
- > With hexagon shaft and holes for turning, either with a spanner or a tommy bar (626 S / 26 RS-626 S, see table, please order separately)
- > Sizes 6x7 and 8x9 mm with no hole

Code	No.	Contents	Pieces	kg
6528730	KD 626-8	626 6x7 8x9 10x11 12x13 14x15 16x17 18x19 20x22 mm 626 S 1 2	8	1,434

26 R

Tubular box spanner

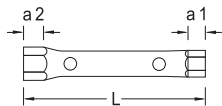

- > With different key widths
- > With hollow shaft, in tubular steel, DIN 2391 seamless, hardened, made from material C35, chrome-plated
- > With hole for tommy bars 26 D and 26 RS (please order separately)

*** not standardised**

Code	No.	Ø	L	26 D	26 RS
6222810*	26 R 5,5X7	5,5 x 7	105	6	1
6210050	26 R 6X7	6 x 7	105	6	1
6210210	26 R 8X9	8 x 9	105	6	1
6210480	26 R 8X10	8 x 10	120	6	1
6210640	26 R 10X11	10 x 11	120	6	1
6210720	26 R 10X13	10 x 13	140	8	2
6210800	26 R 11X13	11 x 13	140	8	2
6210990	26 R 12X13	12 x 13	140	8	2
6211020	26 R 12X14	12 x 14	140	8	2
6211100*	26 R 13X14	13 x 14	140	8	2
6211290*	26 R 13X15	13 x 15	140	8	2
6211370	26 R 14X15	14 x 15	140	8	2
6211450	26 R 13X17	13 x 17	150	10	2
6211530	26 R 14X17	14 x 17	150	10	2
6211610	26 R 16X17	16 x 17	150	10	2
6223030	26 R 16X18	16 x 18	150	10	2
6211880	26 R 17X19	17 x 19	155	12	3
6211960	26 R 18X19	18 x 19	155	12	3
6212180	26 R 19X22	19 x 22	165	12	3
6212260	26 R 20X22	20 x 22	165	12	3
6212340	26 R 21X23	21 x 23	165	14	3
6212420	26 R 22X24	22 x 24	180	14	3
6212500	26 R 24X26	24 x 26	180	14	3
6212690	26 R 24X27	24 x 27	180	14	3
6212770	26 R 25X28	25 x 28	195	16	3
6212850	26 R 27X30	27 x 30	195	16	3
6212930	26 R 27X32	27 x 32	195	16	3
6213070	26 R 30X32	30 x 32	195	16	3
6213150	26 R 30X36	30 x 36	215	18	-
6213230	26 R 32X36	32 x 36	215	18	-
6213310	26 R 36X41	36 x 41	215	18	-
6213580	26 R 41X46	41 x 46	235	20	-
6213660	26 R 46X50	46 x 50	235	20	-
6213740	26 R 50X55	50 x 55	235	20	-

26 RS

Stepped tommy bar



Code	No.	Ø 1	Ø 2	Ø 3	↳ mm ◀
6219350	26 RS 1	5,00	6,00		190
6219430	26 RS 2	8,00	10,00		240
6528220	26 RS-626 S-3	11,70	13,70	16,00	310

KD 26 R

Tubular box spanner set



- > Practical assembly of double socket wrenches with rotary pins
- > Acc. to DIN 896, Form B, ISO 2236, ISO 1085
- > With hollow shaft, in tubular steel, DIN 2391 seamless, hardened, made from material C35, chrome-plated

Code	No.	Contents	Pieces
6218540	KD 26 R-8	26 R 6x7 8x9 10x11 12x13 14x15 16x17 18x19 20x22 mm 26 RS 1 2 3	8
6218890	KD 26 R-120	26 R 6x7 8x9 10x11 12x13 14x15 16x17 18x19 20x22 21x23 24x27 25x28 30x32 mm 26 RS 1 2 3	12

45 S

Multi fitting key
UNIVERSAL



- > Key for opening and closing of master cabinets, switch panels, technical shut-off systems e.g. air-conditioning, inspection flaps
- > For the outdoor areas - locking of bins or waste containers, and street lamp lids etc.
- > 5 mm square for radiator valves

- > Female square 5, 6, 7-8 mm
- > Female three-square 9 mm
- > Multi fitting key 3-5 mm

Code	No.	Measurements
2190125	45 S	72 x 72

40

Hook wrench
with lug

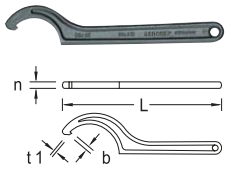

- > Design according to DIN 1810 form A
- > For slotted round nuts according to DIN 981

Code	No.	mm	L	Code	No.	mm	L
6333990	40 16-20	16-20	110	6334960	40 80-90	80-90	280
6334020	40 25-28	25-28	135	6335180	40 95-100	95-100	280
6334100	40 30-32	30-32	135	6335260	40 110-115	110-115	335
6334290	40 34-36	34-36	170	6335340	40 120-130	120-130	335
6334370	40 40-42	40-42	170	6335420	40 135-145	135-145	385
6334450	40 45-50	45-50	205	6335500	40 155-165	155-165	385
6334530	40 52-55	52-55	205	6335690	40 180-195	180-195	465
6334610	40 58-62	58-62	240	6335770	40 205-220	205-220	465
6334880	40 68-75	68-75	240				

40 Z

Hook wrench
with pin

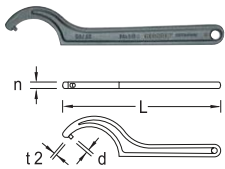

- > Design according to DIN 1810 form B
- > For cross-drilled nuts according to DIN 1816

Code	No.	mm	L	Code	No.	mm	L
6335850	40 Z 16-18	16-18	110	6337200	40 Z 68-75	68-75	240
6335930	40 Z 20-22	20-22	110	6337390	40 Z 80-90	80-90	280
6336580	40 Z 25-28	25-28	135	6337470	40 Z 95-100	95-100	280
6336660	40 Z 30-32	30-32	135	6337550	40 Z 110-115	110-115	335
6336740	40 Z 34-36	34-36	170	6337630	40 Z 120-130	120-130	335
6336820	40 Z 40-42	40-42	170	6337710	40 Z 135-145	135-145	385
6336900	40 Z 45-50	45-50	205	6337980	40 Z 155-165	155-165	385
6337040	40 Z 52-55	52-55	205	6338010	40 Z 180-195	180-195	465
6337120	40 Z 58-62	58-62	240	6338280	40 Z 205-220	205-220	465

44

Caliper face spanner
adjustable 0-30 mm

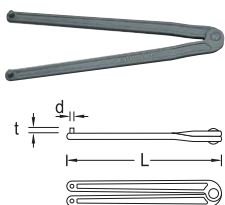

- > For loosening and clamping of cutting and grinding wheels
- > Similar to DIN 3116
- > Special sizes available on request

Code	No.	mm	L	L"	Code	No.	mm	L	L"
6354480	44 3	3	178	7"	6354720	44 6	6	230	9"
6354560	44 4	4	178	7"	6354990	44 8	8	230	9"
6354640	44 5	5	230	9"					